



LuK Service Info



Part Nr: 631 0261 19 — 310/310mm XGW6

Manufacturer: NEW HOLLAND - FIAT

Info: Flywheel Information/
Schwungradinformation/
Informations de volant-moteur/
Información del Volante-motor/
Informazioni volano

Art.-Nr.: 631 0261 19





631 0261 19
631 0261 12 = 631 0261 19 + 500 0786 30
631 0261 13 = 631 0261 19 + 500 0059 10 + 410 0026 41

 The location recess of 0.5mm depth and external register diameter of 362.114 – 362.290mm must be restored when flywheel is machined.

guide de 362.114 – 362.290 mm lorsque le volant-moteur est rectifié.

 Bei der Bearbeitung des Schwungrads müssen die Einbautiefe von 0,5 mm und der externe Registerdurchmesser von 362.114–362.290 mm wiederhergestellt werden.

 Deben mantenerse la distancia relativa a la zona de fricción a 0,5 mm de profundidad y el diámetro de fricción externo a 362.114 – 362.290 mm cuando el volante esta mecanizado.

 Il faut restaurer l'épaule de montage de 0,5 mm de profondeur et le diamètre de l'épaulement

 Riportare la cavità della sede ad una profondità di 0,5 mm e il diametro di centraggio esterno a 362.114 – 362.290 mm quando si rettifica il volano.

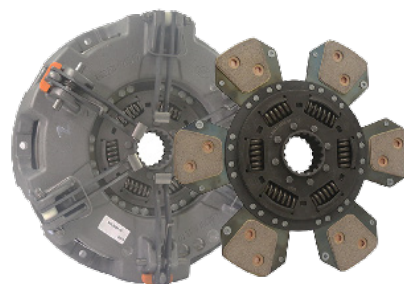
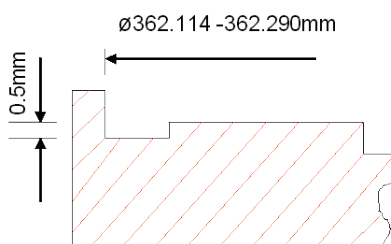

631 0261 19

 **6 x M10 x 1.25 x 45mm cap head bolts + spring washers 411 0012 11**

- For accurate model information please see LuK catalogue
- Die genaue Fahrzeugzuordnung entnehmen Sie bitte dem LuK-Katalog
- Pour plus d'information sur les applications veuillez vous référer au catalogue LuK
- Para obtener información sobre el modelo, rogamos consulte el catálogo de LuK
- Per informazioni sul modello consultare il catalogo LuK

You want more? We can help!

Phone: +44 (0) 1432 264 264

Fax: +44 (0) 1432 375 760

aftermarket.uk@schaeffler.com

www.repexpert.co.uk

SCHAEFFLER
REP>XPERT