

LuK GearBOX, Part Number: 462 0055 10

Transmission Data



- ▶ **Manufacturer:** Volkswagen Group
- ▶ **Type:** 02T / 0AF / 0AP
- ▶ **Design:** 5-speed manual transmission

Fleet Data



- ▶ **Vehicles:** Audi: A1, A2, A3
SEAT: Altea, Arona, Cordoba, Ibiza, Inca, ...
Skoda: Fabia I+II, Oktavia II+III, Rapid
VW: Bora, Golf IV+V+VII, Lupo, New Beetle, Polo
- ▶ **Fleet (VIO):** approx. 13 million vehicles linked via K-Type-#

Box Content

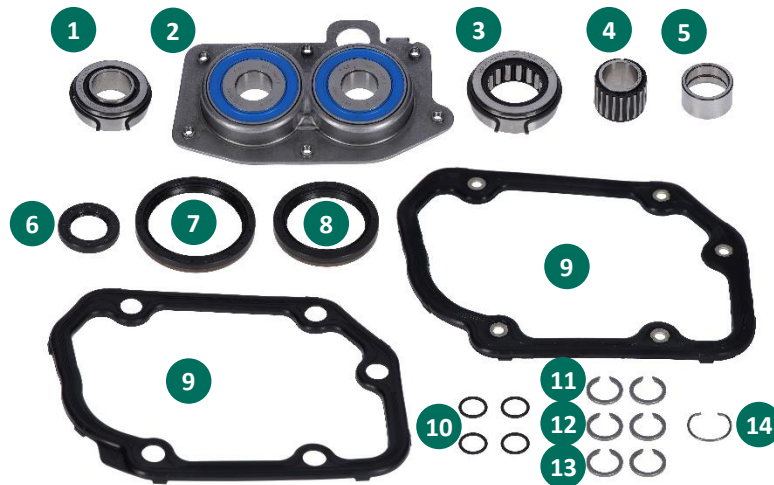

Information



- ▶ A typical failure is wear of the bearing shaft seat with double ball bearing which will be indicated by a rattling noise. This can result in the failure of the 5th gear needle roller bearing (see No. 4).
- ▶ The set does not include differential bearings. These are available separately from Schaeffler (712 1304 10 and/or 712 1308 10).
- ▶ A special repair manual is available on REPERT.
- ▶ Special tool (400 0521 10) for disassembly and assembly available.

No.	Description	Mounting Position	Part	Dimensions (mm)
1	Main bearing input shaft	Engine side	Roller bearing	24.10 x 47.00 x 17.70
2	Main bearing input/output shaft	Gearbox side	Double ball bearing	172.00 x 108.00 x 38.00
3	Main bearing output shaft	Engine side	Roller bearing	26.00 x 55.00 x 18.00
4	Idler gear bearing and inner ring 5th gear	Gearbox side	Needle roller bearing	27.00 x 32.00 x 24.80
5	Inner ring output shaft*	Engine side	Inner ring	21.80 x 27.00 x 25.80
6	Seal input shaft	Engine side	Shaft sealing ring	
7	Seal differential	Engine side	Shaft sealing ring	
8	Seal differential	Gearbox side	Shaft sealing ring	
9	Seal cover 5th gear*		Flat gaskets	
10	Seal bearing journals		O-ring	
11	Circlip 5th gear*		Adjusting ring	17.70 x 2.00
12	Circlip 5th gear*		Adjusting ring	17.70 x 2.10
13	Circlip 5th gear*		Adjusting ring	17.70 x 2.20
14	Circlip Inner ring Main bearing output shaft*	Engine side	Circlip	

*Optional to use