

Einbauanleitung
 Fitting instructions
 Istruzioni di montaggio
 Notice de montage
 Instrucciones de montaje
 Monteringsanvisning

CORTECO

MERCEDES-BENZ B-Klasse

80004408
 80004409

11.11 ->



The Perfect Change.

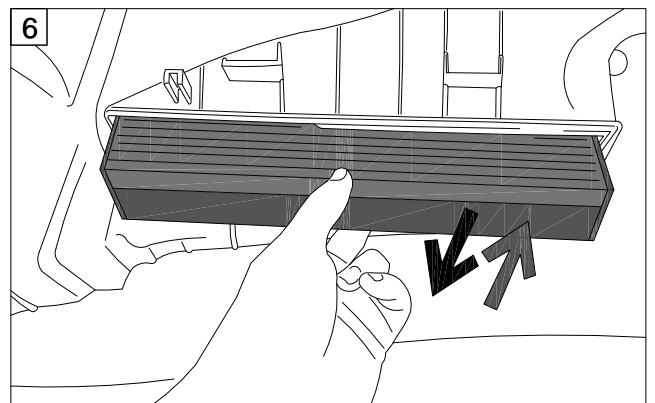
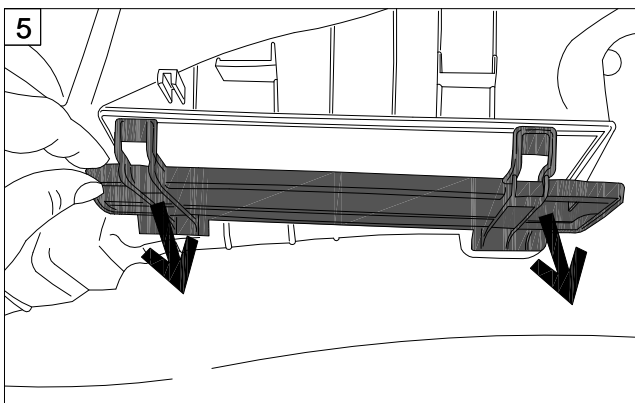
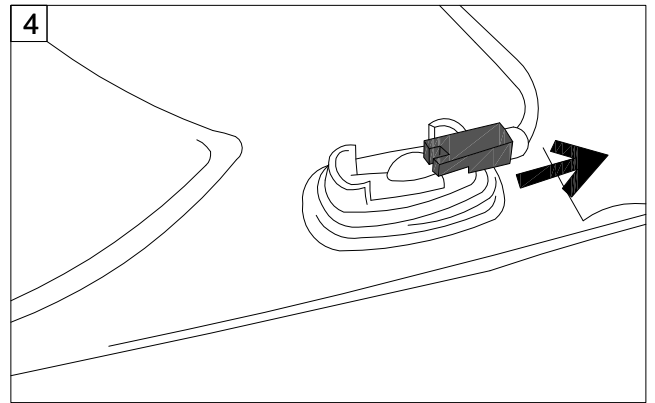
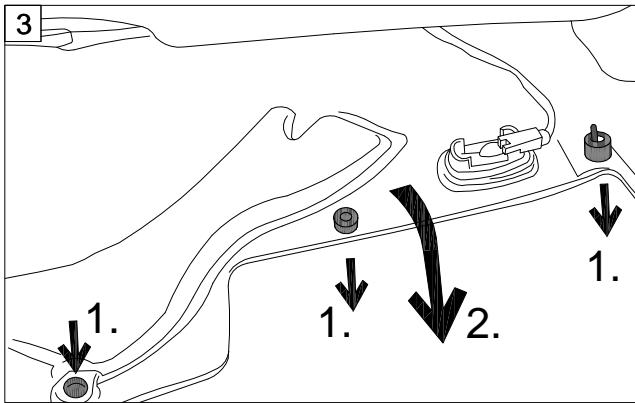
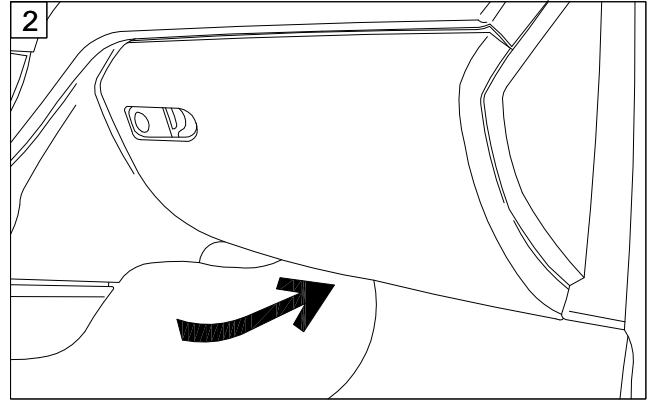
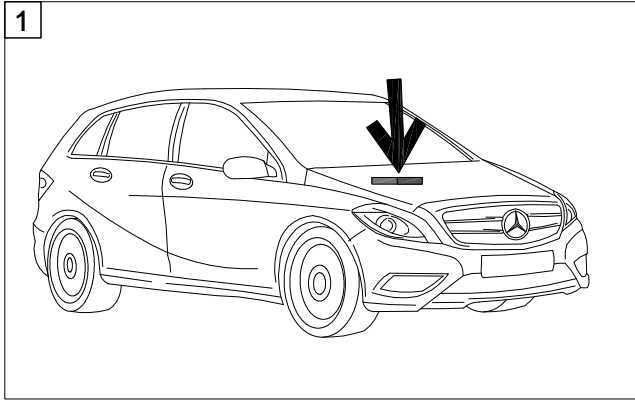

7

365

0	1	5	0	0	0	km
0	1	0	0	0	0	Miles