



### DANGER

**Airbag unit can trigger unintentionally!**

**Airbag unit is a pyrotechnic component that can lead to death on improper handling!**

**Only specially trained employees may carry out any work on the airbag system.**

**Disconnect the battery.**

**Always store airbag unit with the padded side pointing upward.**

**Always transport airbag unit in appropriate packaging.**

**Never leave airbag unit unattended, but lock safely in an appropriate cabinet.**

**Do not open or repair airbag unit.**

**Only install airbag unit in undamaged condition.**

**Do not perform any measurements on the airbag unit using a test lamp or multimeter.**

**Wear protective gloves and safety goggles.**

**No person may stay inside the vehicle when re-connecting the battery.**

### Remove:

**Move steering wheel to the centre position and let steering lock engage.**

Switch off ignition.

**Wait 20 minutes after switching off the ignition.**

**Disconnect battery (negative terminal).**

**Keep waiting time of min. 10 min.**

Carefully remove gearshift lever cover(s) using a lever and place over gearshift knob. **(1)**

Disconnect electric connectors.

Unscrew cover screw(s). **(2)**

Remove cover(s) at side of dashboard. **(3)**  
(see Figure 1)

Figure 1

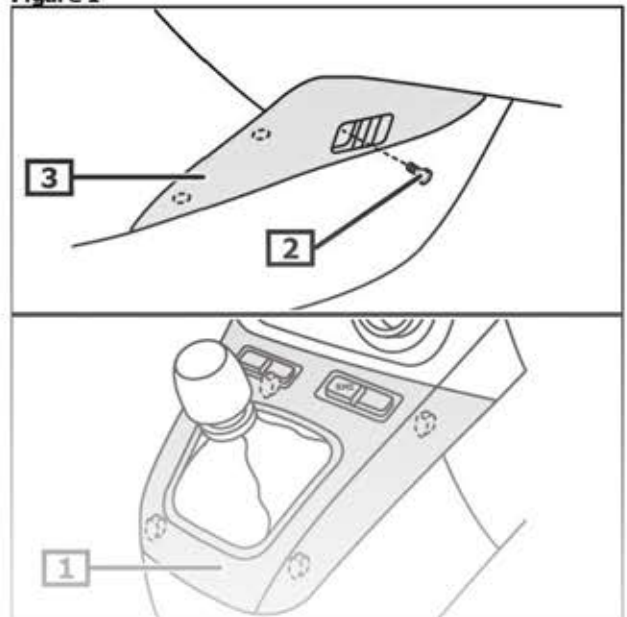

1 Gearshift lever cover(s)

2 Cover screw(s)

3 Cover(s) at side of dashboard

This document is no longer available on Tech Corner. In order to view this and other content, register now for ZF Services [pro]Tech. More information and the registration form can be found under the following link:

<https://protech.zf.com>

